

C. 99-43

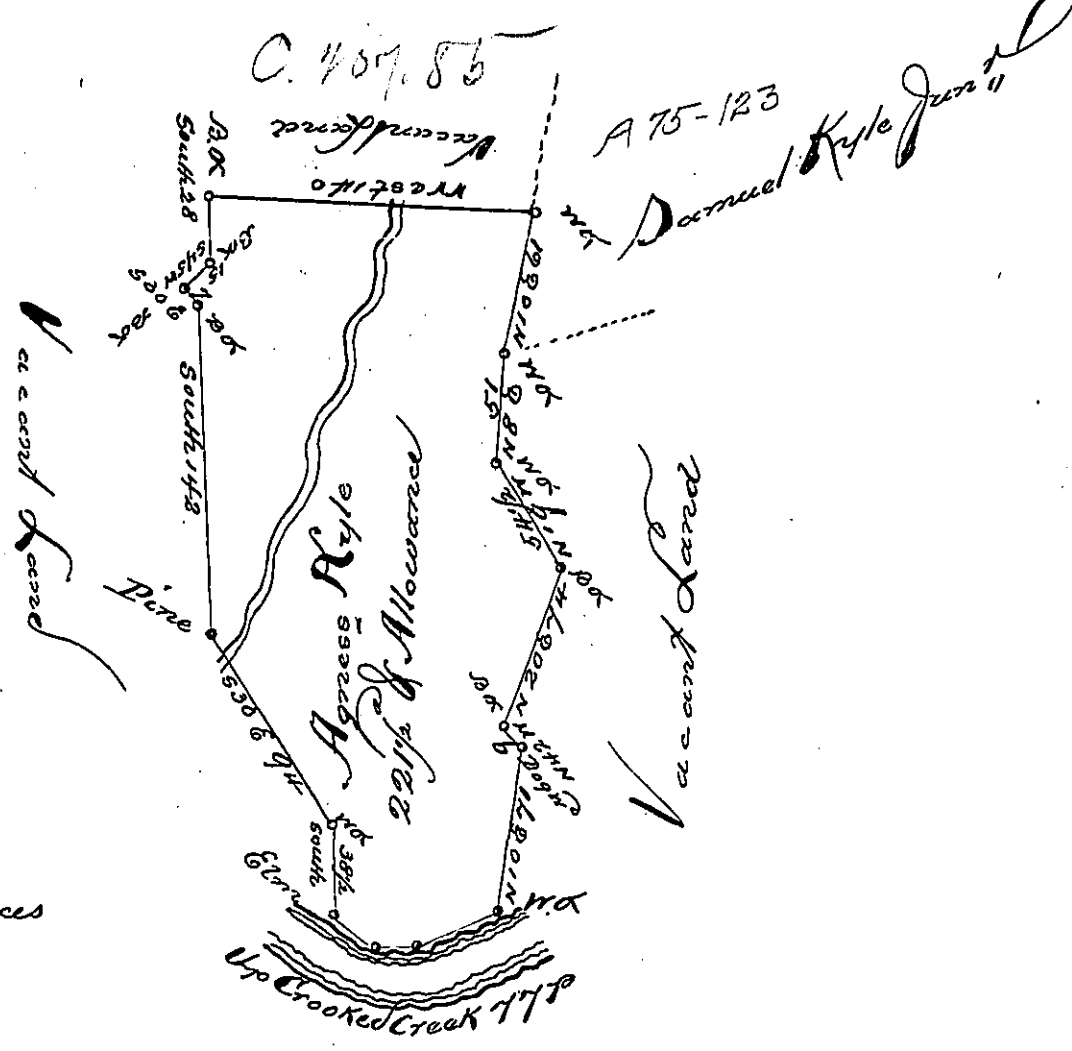

Courses & Distances  
up the Creek.

S. 45. E. 2170  
East 18  
N 70. E 38  
m. 77 perches

Dunby's to Agnese Kyle on the 14<sup>th</sup> day of October 1786. The above Described Tract of Two hundred & twenty-one acres & one half of an acre & a narrowed of said pr. Cont. Situate on a Run emptying into Crooked Creek on the North side of said Creek, about six miles from Fergus Moorhead's in Westmoreland County. By warrant of the 5<sup>th</sup> Day of August 1785

John Lukens Esq<sup>r</sup>  
J. Genl.

Joshua Elder D. J.

IN TESTIMONY that the above is a copy of the original remaining on file in the Department of Internal Affairs of Pennsylvania, made conformably to an Act of Assembly approved the 16th day of February, 1833, I have hereunto set my Hand and caused the Seal of said Department to be affixed at Harrisburg, this Seventh day of May, 1901,

James W. Latta  
Secretary of Internal Affairs.